

# Air Oxygen Transmitter incl. Electrode OXY 3690 MP



- O<sub>2</sub>-sensor element exchangeable
- Appropriate to air with high CO<sub>2</sub>-concentrations
- Input electrically isolated

## Characteristics

The OXY 3690 MP measures the oxygen concentration in air. Depending on the selected design type the device is appropriate to either pure oxygen (i.e. low CO<sub>2</sub> concentration) or to air with very high CO<sub>2</sub> concentration.

## Technical data

Measuring range  
 Oxygen concentration : 0.0..100.0 % O<sub>2</sub>  
 Temperature : -20.0..+50.0 °C  
 Accuracy (transmitter) at 20.9 % O<sub>2</sub>, 1000 mbar abs.  
 Oxygen : ±0.1 % ± 1 digit  
 Temperature : ±0.1 °C ± 1 digit  
 Output signal (only O<sub>2</sub>) : 4..20 mA (2-wire)  
 0..10 V (3-wire)  
 Electrical isolation : input electrically isolated  
 Working temperature : 0..50 °C  
 Power supply : 12..30 V DC at 4..20 mA  
 18..30 V DC at 0..10 V  
 Permissible impedance :  $R_A [\Omega] = (U_V [V] - 12 V) / 0.02 \text{ mA}$   
 Permissible load :  $R_L > 3000 \Omega$   
 Reverse voltage protect.: 50 V permanent  
 Display : 10 mm high, 4-digit LCD display  
 Electric connection : elbow-type plug (EN 175301-803/A),  
 max. wire cross-section: 1.5 mm<sup>2</sup>,  
 wire diameter from 4.5..7.0 mm  
 Sensor connection : 5-pole screw-able diode socket  
 Calibration : 1-point-calibration at atmospheric air  
 Air pressure compensat.: 500..2000 hPa abs., manual input  
 Over- / under-pressure : max. 0.25 bar  
 Housing : ABS

## O<sub>2</sub>-sensor element

	GOEL 370
Measuring range	0.0..100.0 % O <sub>2</sub>
Response time T <sub>90</sub>	< 10 s
Application	for air or pure oxygen or for air or air with high CO <sub>2</sub> -concentration
	GOEL 380
Measuring range	0.0..25.0 % O <sub>2</sub>
Response time T <sub>90</sub>	< 5 s
Application	for air with little CO <sub>2</sub> -concentration, response time shoots

Temp. compensation : integrated in oxygen sensor  
 Connection cable : 1.3 m with 5-pole screw-able diode plug  
 Working pressure : 500..2000 hPa (static)  
 for air or gas inflow option GOO (oxygen probe GOO ... / MU) is needed

## Dimensions

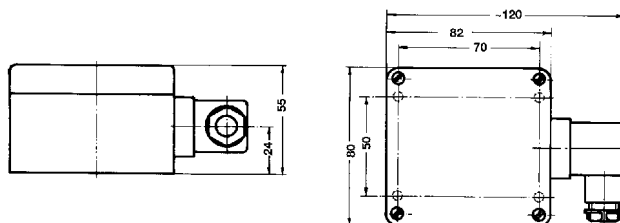

Measuring probe : Ø 40 x 103 mm  
 (153 mm incl. bend protection)

## Ordering code

OXY3690MP -  -  -  -

<b>1. O<sub>2</sub>-sensor element</b>	
0	GOEL 370 for air and pure oxygen
1	GOEL 380
<b>2. Sensor design</b>	
GGO	closed sensor design (suited for over- and under- pressure, used at gas-tight systems)
GOO	open sensor design (e.g. suitable for air or gas inflow, pressure cannot be built up)
<b>3. Output signal</b>	
A1	4..20 mA (2-wire)
V2	0..10 V (3-wire)
<b>4. Cable length</b>	
L01	1.3 m cable
L10	10 m cable

Ordering example: OXY3690MP-0-GGO-A1-L01

## Accessories / Spare parts

### GOEL 370

Spare sensor element